

Robust Metal Utility/Terminal Boxes

Stainless Steel 304 & 316



Powder Coated Steel



SPECIFICATIONS:

- Material & finish
 - 1.5mm SS304 & SS316 hairline finished
 - 1.5mm Electro-Galvanised Steel sheet, polyester powder coating RAL 7032 (CVS beige colour)
- Internal bracket – as above
- Polyurethane gasket on lid forms a continuous seal
- Double fold on base opening for strength and to channel water away from seal
- Earthing studs in base and lid
- Pre-punched holes on internal bracket for fixing din rail and mounting plate
- 4 fixing holes for direct mounting to wall
- Accessories – din rail, mounting plate and wall mounting bracket

Box Dimensions

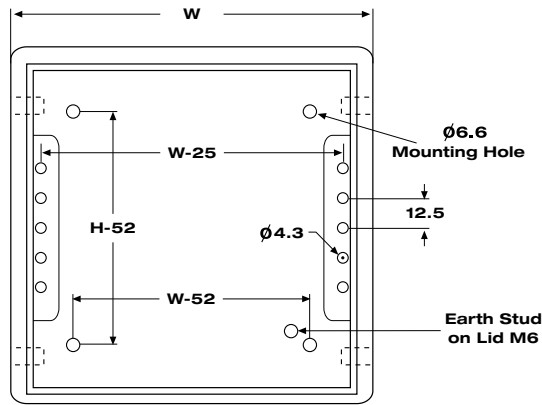
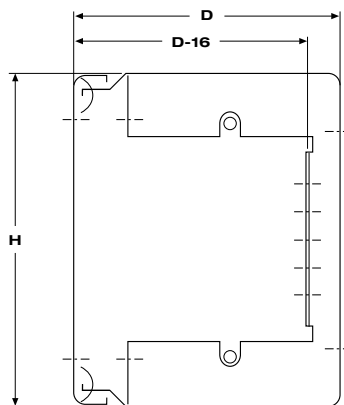

Front View



ORDERING INFORMATION - Boxes

Stainless Steel

PART NO	DIMENSIONS MM	
CTX151512	150H x 150W x 120D	304 Grade
CTX202012	200H x 200W x 120D	304 Grade
CTXX151512-316	150H x 150W x 120D	316 Grade
CTXX202012-316	200H x 200W x 120D	316 Grade

Powder Coated Steel

PART NO	DIMENSIONS MM
CT151512	150H x 150W x 120D
CT202012	200H x 200W x 120D