

OLSEN DUAL COLOUR BATTEN SUITABLE FOR CEILING AND WALL MOUNTING OR SUSPENDING

SAFETY INFORMATION:

To ensure correct function and safety, please read and follow all instructions carefully before using the product:

- Turn off power before installation or before doing any maintenance work.
- Turn off power before setting or changing the CCT colour mode switch.
- Do not install any luminaire near a heat source.
- For indoor use only. Do not install this luminaire in damp or wet locations.
- Do not exceed the nominal supply voltage or amperage ratings.
- Take care not to pull any electrical wires during unpacking as this may damage the connection.
- Lay out all the components on a smooth surface and make sure there are no components missing before assembling.
- To avoid injury or damage to the fitting, please ensure that power leads and screws are secure before connecting the power.
- All wiring and installation of the light fitting must adhere to AS/NZS 3000 Wiring Rules.

THIS IS A CLASS 1 PRODUCT AND MUST BE EARTHED

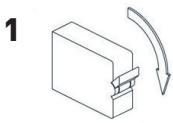

1 Isolate mains power

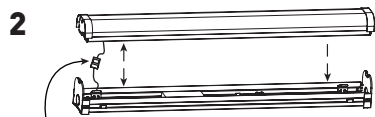

2 (A) Remove diffuser by depressing the 4 clips to release
(B) Unplug the Power Connection



3 Feed mains cable through grommet in base tray



4 Mark fixing holes

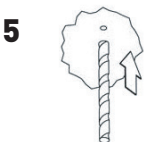

5 Drill holes

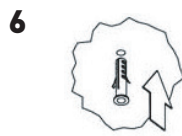

6 Insert rawl plugs



7 Fix in position minimum 2 spaces

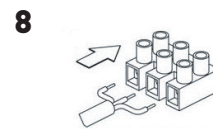

8 Terminate mains cable Live, Earth, Neutral and securely clamp the supply cable



9 Connect the power connection, select colour temperature and ensure all the 4 clips engage

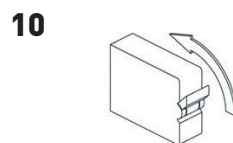

10 Restore mains power and test to ensure correct operation

Vynco Industries (NZ) Limited

Christchurch Office

388 Tuam Street, Phillipstown, Christchurch, 8011
PO Box 9022, Tower Junction, Christchurch 8149
New Zealand
P +64 3 379 9283 F +64 3 379 6838
E sales@vynco.co.nz
www.vynco.co.nz

Auckland Office

9 Levene Pl, Mount Wellington
PO Box 12 249, Penrose, Auckland 1061
New Zealand
P +64 9 525 6051 F +64 9 525 5799
E sales@vynco.co.nz
www.vynco.co.nz

OLSEN DUAL COLOUR BATTEN SUITABLE FOR CEILING AND WALL MOUNTING OR SUSPENDING

INSTALLATION INSTRUCTIONS:

- Switch off before installation.
- Switch on only after complete installation and examination of the circuit.
- Installation and maintenance should only be completed by a registered electrician.

Turn Off power supply before starting any installation. Read instructions & check you have all the tools & accessories to complete the installation correctly.

Step 1

Press the snap-on button and remove the cover.

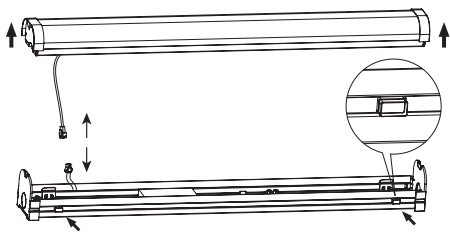

Step 3

Connect the DC plug. Press the snap-on button and fix the cover to the base.

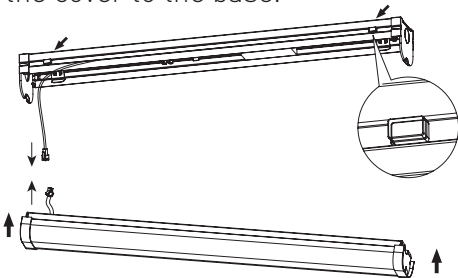

Step 4

Installation complete.



Step 2

Knock plastic anchor into ceiling.
Connect the cable to terminal block. Fix the base to the ceiling.

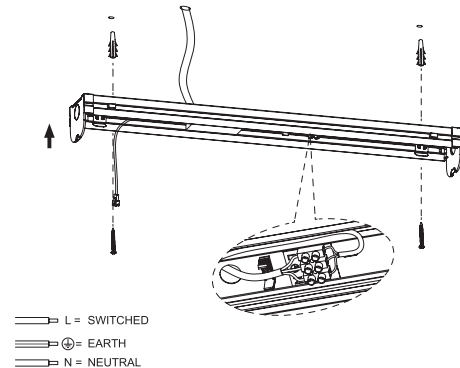

WARRANTY:

This product is covered by the standard 3 year Vynco Warranty - proof of purchase is required.

Please contact Vynco for details of returns procedure.

NOTE: This product contains NO user serviceable parts.

Vynco Industries (NZ) Limited

Christchurch Office

388 Tuam Street, Phillipstown, Christchurch, 8011

PO Box 9022, Tower Junction, Christchurch 8149

New Zealand

P +64 3 379 9283 F +64 3 379 6838

E sales@vynco.co.nz

www.vynco.co.nz

Auckland Office

9 Levene Pl, Mount Wellington

PO Box 12 249, Penrose, Auckland 1061

New Zealand

P +64 9 525 6051 F +64 9 525 5799

E sales@vynco.co.nz

www.vynco.co.nz